

MITSUBISHI MOTORS
GENUINE PARTS

OUTLANDER/ENDEAVOR

ASHTRAY

MZ360043EX

INSTALLATION AND HANDLING INSTRUCTIONS

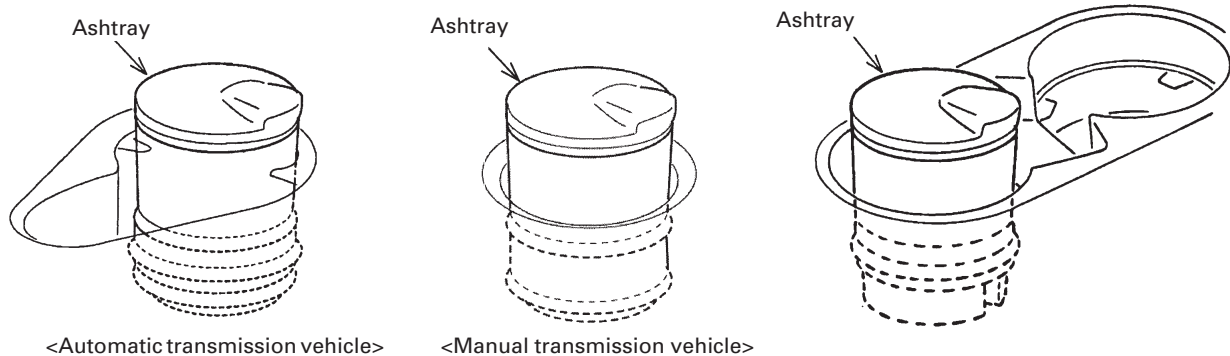

<Automatic transmission vehicle>

<Manual transmission vehicle>

OUTLANDER

ENDEAVOR

Thank you for purchasing the Mitsubishi Genuine Accessory.
To install and use the product correctly with proper knowledge of it, read this publication carefully.
Keep this publication for reference when maintenance is required.

Attention

- This publication gives precautionary instructions in the boxes titled as follows.
Read through these instructions thoroughly.



Caution

Describes precautions that should be observed in order to prevent injury or damage to the vehicle or its components, which may occur if sufficient care is not taken.



Note

Provides additional information that facilitates installation work.

- Failure to follow these instructions not only prevents the product from working properly but may lead to trouble with the vehicle. Be sure to follow all instructions carefully.
- If there is anything unclear about the installation, handling and/or usage of the product, contact your Mitsubishi Motors dealer for clarification.
- Mitsubishi Motors Corporation is not responsible for any defects or difficulties caused by or resulting from the failure to follow given instructions.
- We recommend you to have the installation performed at an authorized Mitsubishi Motors dealer.

To the dealer:
Be sure that the customer receives this publication.

■ **COMPONENTS** (Make sure that all of the following components were included in the kit.)

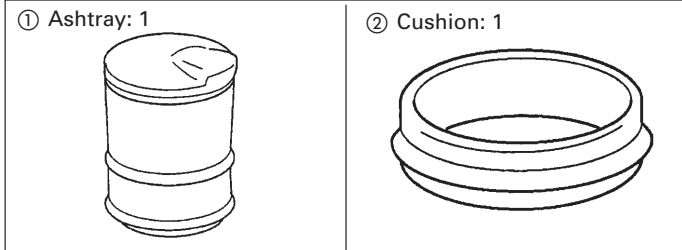

INSTALLATION PROCEDURES

A. INSTALLING THE ASHTRAY

OUTLANDER

<Automatic transmission vehicle>

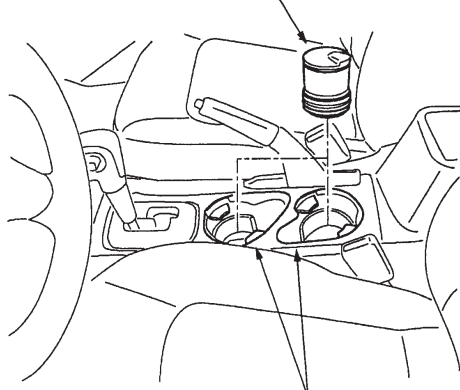
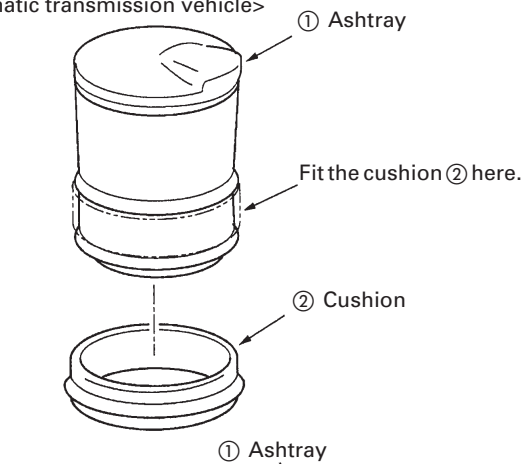

<Manual transmission vehicle>

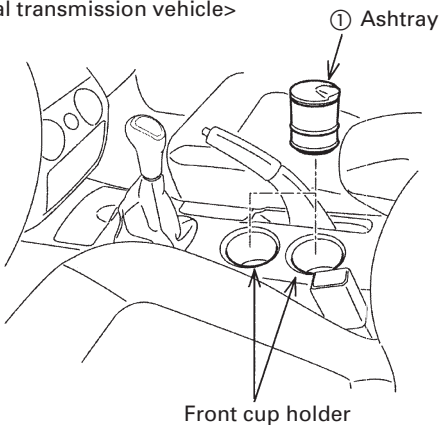

- 1) Automatic transmission vehicle: Fit the cushion ② snugly onto the existing cushion on the ashtray ① as shown in the illustration.

Caution

If the cushion ② is out of position, the ashtray ① cannot be secured.

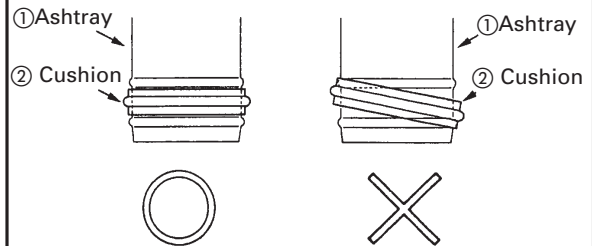

Manual transmission vehicle: Use of the cushion ② is not needed.

- 2) Install the ashtray ① into the cup holder in the floor console.

Caution

- Push the ashtray ① all the way into the cup holder so that it is held in place.
- The ashtray ① is only for installation in the front cup holder. Do not install it in the rear cup holder.

Check

ENDEAVOR

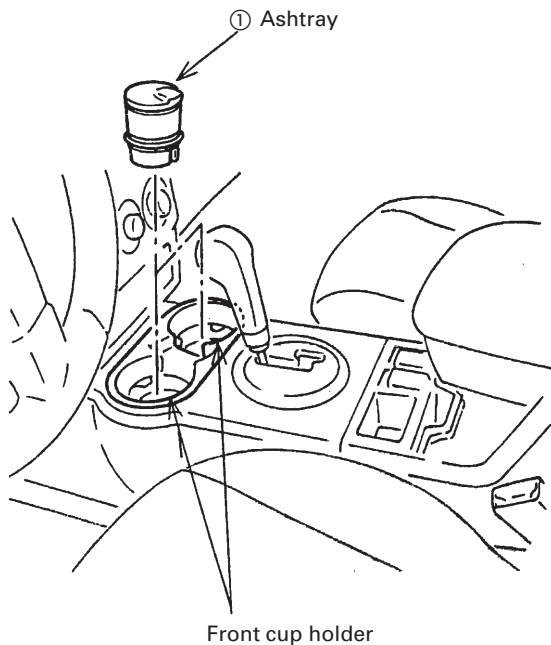
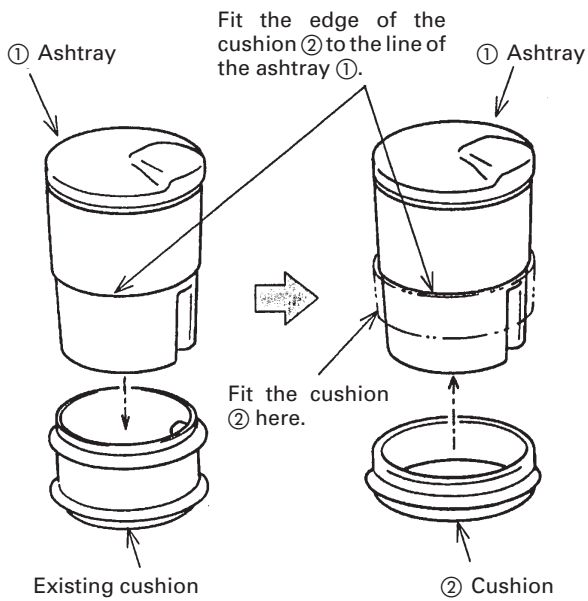

- 1) Remove the existing cushion from the ashtray ①.

Note

The removed cushion is not used.

- 2) Fit the cushion ② in position onto the ashtray ① as shown in the illustration at the left.

Caution

If the cushion ② is out of position, the ashtray ① cannot be secured.

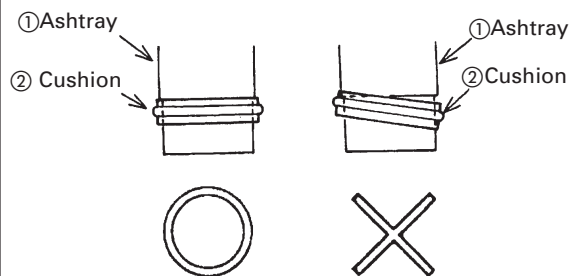

- 3) Install the ashtray ① into the cup holder in the floor console.

Caution

- Push the ashtray ① all the way into the cup holder so that it is held in place.
- The ashtray ① is only for installation in the front cup holder. Do not install it in the rear cup holder.
- When removing the ashtray, hold down the cup holder so as not to let the cup holder come off together with the ashtray.

Check

B. CHECKING AFTER INSTALLATION

- Check that the ashtray fits tight in the cup holder.

Check

USAGE

- Use the ashtray exclusively placed in the vehicle's genuine cup holder.

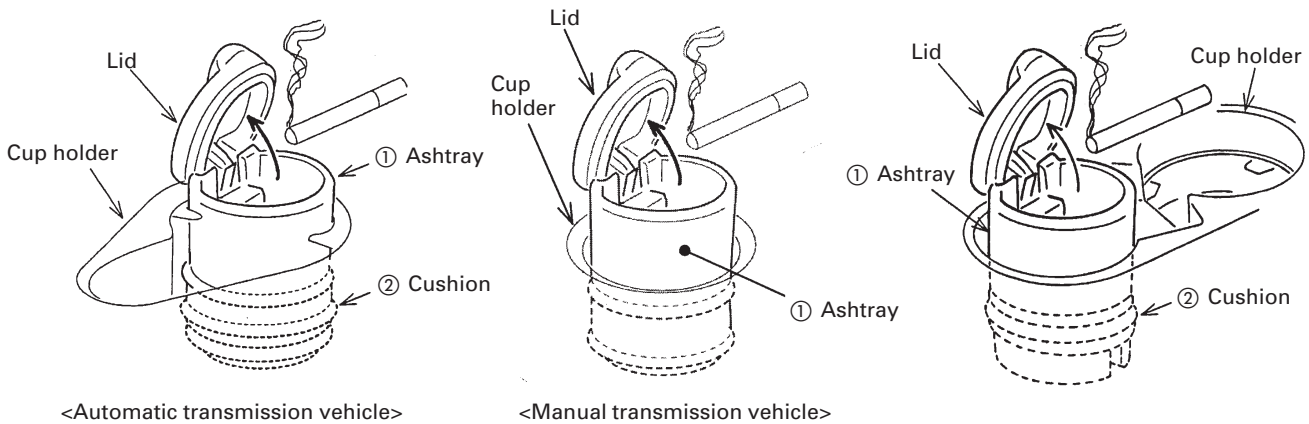

OUTLANDER

ENDEAVOR

Caution

- Be sure to put out the cigarette butt and used match before throwing them into the ashtray. Close the ashtray after use. If the ashtray lid is kept open, other cigarette butts in the ashtray could catch fire.
- Do not leave the ashtray filled with cigarette butts. Do not place pieces of paper and other flammable materials in the ashtray. They could also catch fire.
- Keep the ashtray closed when it is not used. Avoid laying the ashtray on the seat or other places in the cabin, and hold the ashtray straight up before emptying it. Cigarette butts may be thrown out even if it is closed.
- Be careful not to drop the ashtray on a hard surface. Do not apply any stress to the opened ashtray lid. When removing the ashtray from or replacing it in the cup holder, close its lid and hold it by the body. Otherwise, it could be deformed or broken.
- If the cushion slips out of place during removing or reinstalling the ashtray, put it back into place as instructed in the Installation Procedures.

CARE AND HANDLING

- To clean the products, wipe with soft material, such as sponge or chamois leather.
- Do not use any hard material for cleaning, such as a scrubbing brush. It could scratch the surface.
- Do not use polishing powder-compounded wax. It could damage the plastic surface.
- Be sure to prevent contact with gasoline, kerosene, brake fluid, engine oil, grease, paint thinner, sulfuric acid (battery electrolyte) and wax remover that could cause discoloration, staining and cracking. Should any of them contact the surface, wipe it off using neutral detergent-moistened soft cloth or chamois leather immediately, then wash the surface completely with water.