



GENUINE ACCESSORIES

INSTALLATION INSTRUCTIONS

ECLIPSE FUEL DOOR

PART # MZ313512

APPLICATION

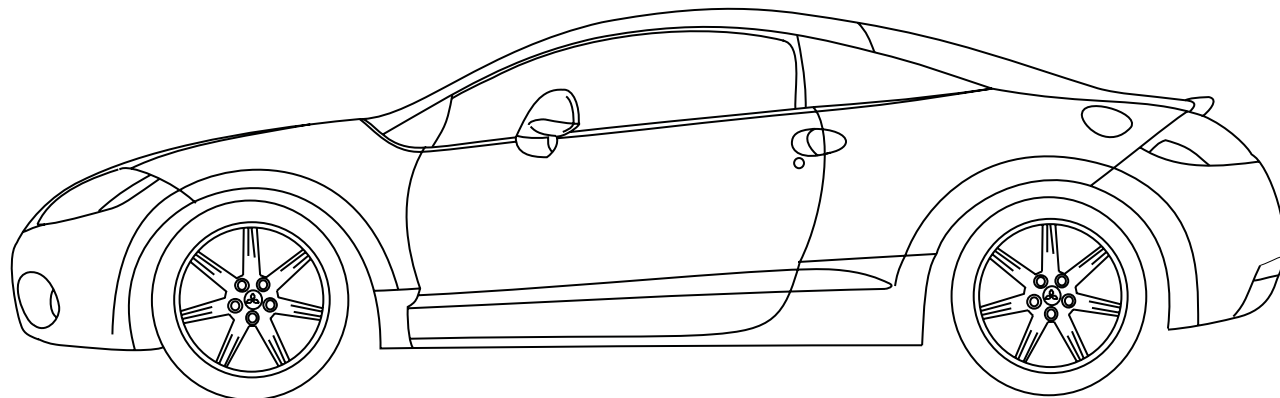

Mitsubishi Eclipse

TOOLS REQUIRED

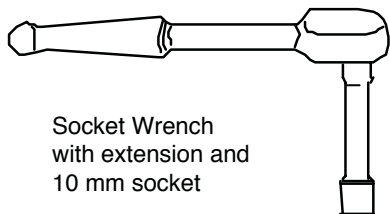

Socket Wrench
with extension and
10 mm socket

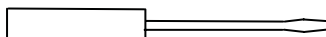

Small Screwdriver



Cleaning Solution



Soft Cloth

BILL OF MATERIALS

① X1

PREMIUM ONLY
SUPER CARBURANT

2006-2010 Eclipse & Spyder

② X1

UNLEADED FUEL ONLY
PREMIUM RECOMMENDED
FOR MAXIMUM PERFORMANCE
(SEE OWNER'S MANUAL)

2011 and later Eclipse & Spyder

③ X1

ESSENCE SANS PLOMB SEULEMENT
Esence « Super » recommandée (91 Octane ou plus)
Pour performance maximale
(Voir guide du propriétaire)

2011 and later Eclipse & Spyder

④ X1



CAUTION: DO NOT DROP ATTACHMENT BOLTS INTO FUEL FILLER PIPE

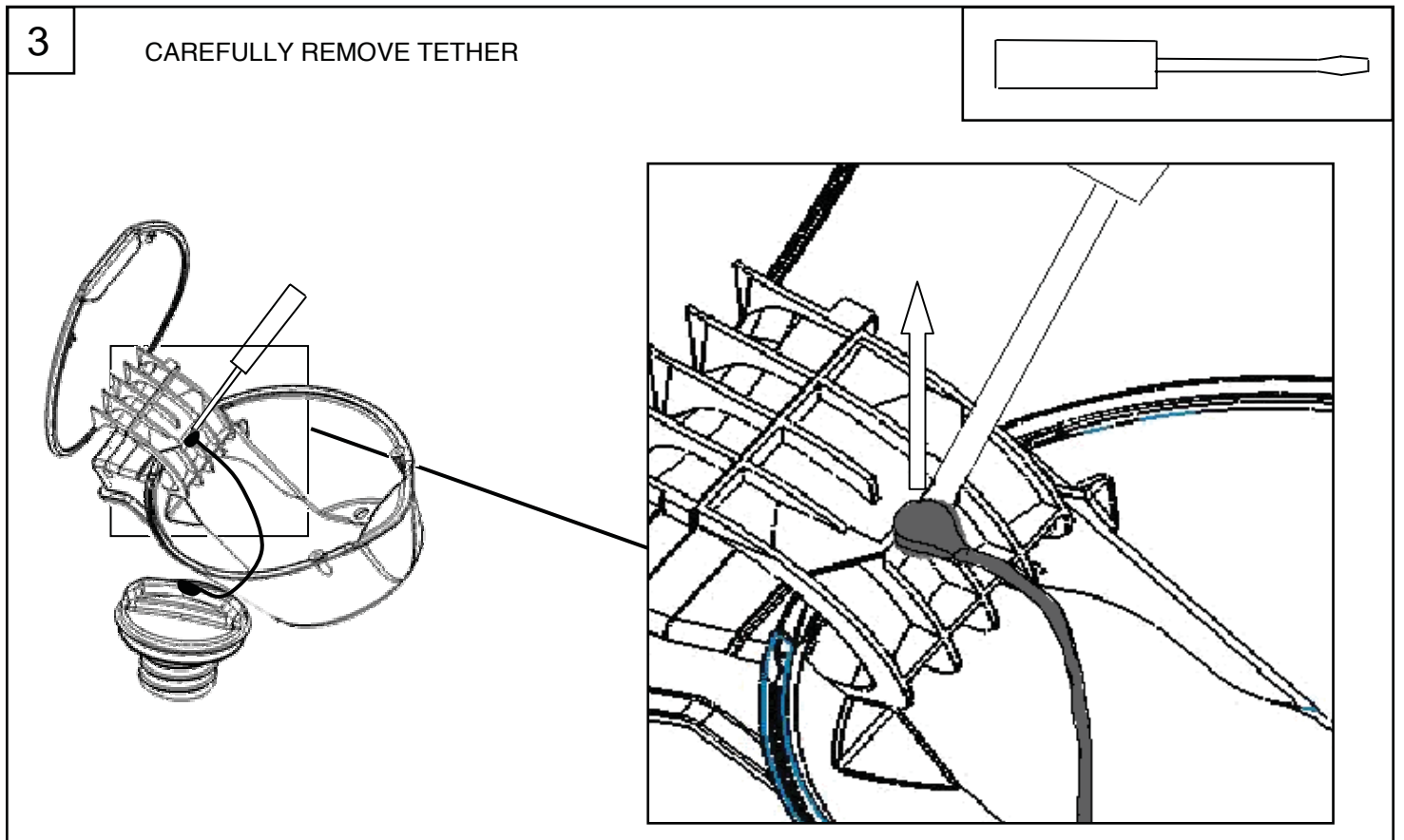
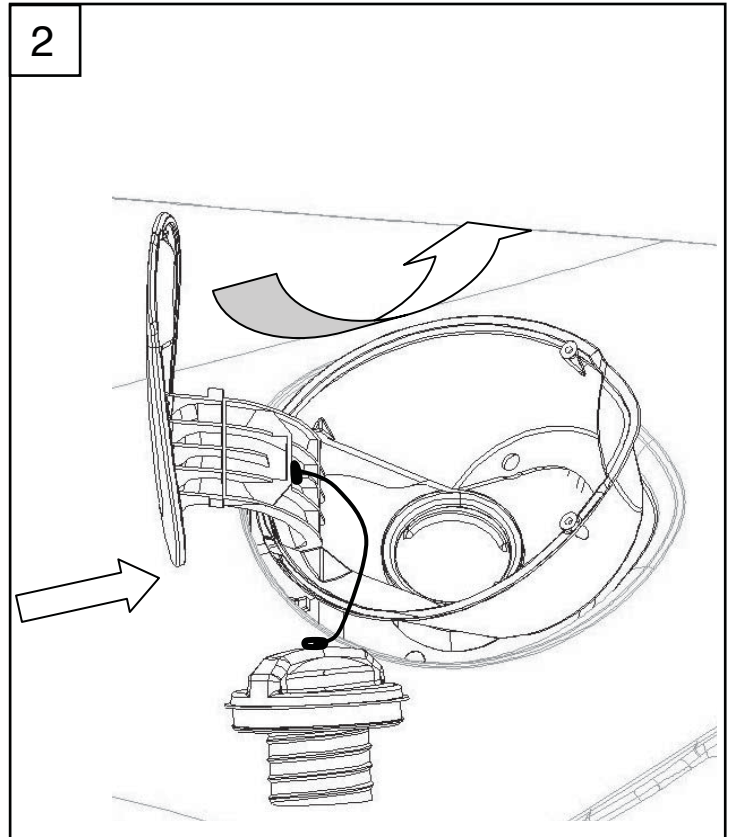
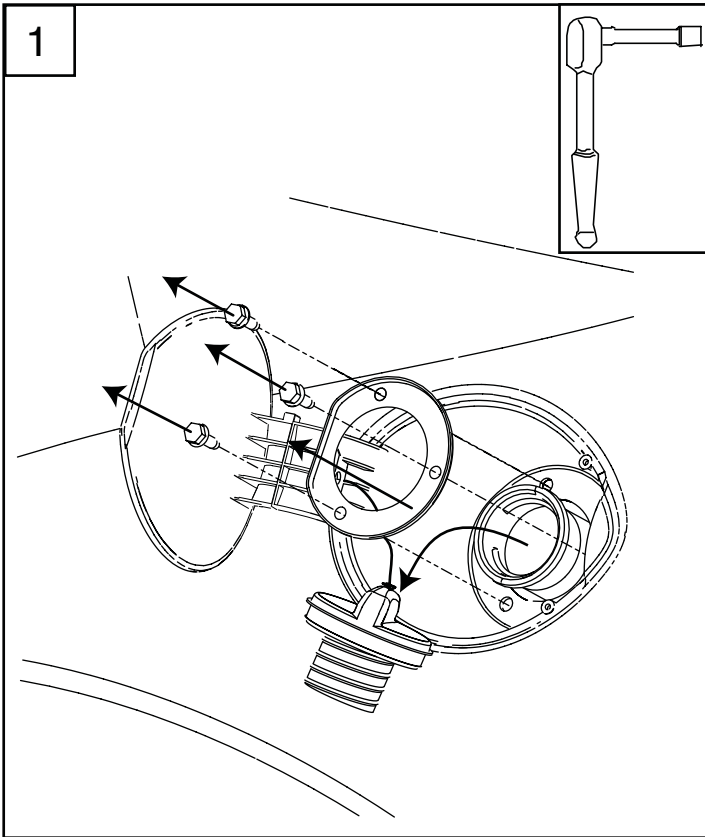

4

CLEAN SHEET METAL WITH DAMP CLOTH AND CLEANING SOLUTION.

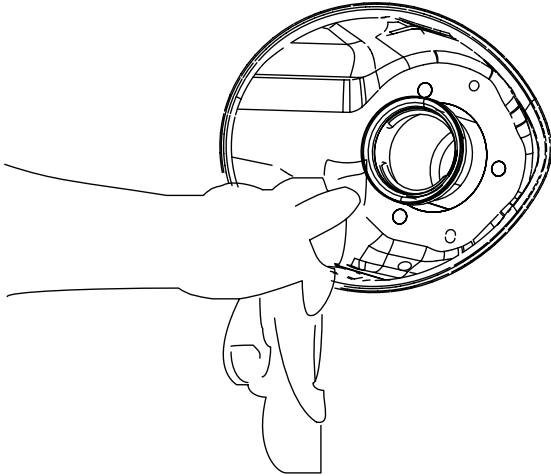
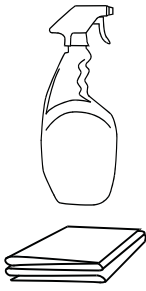

5

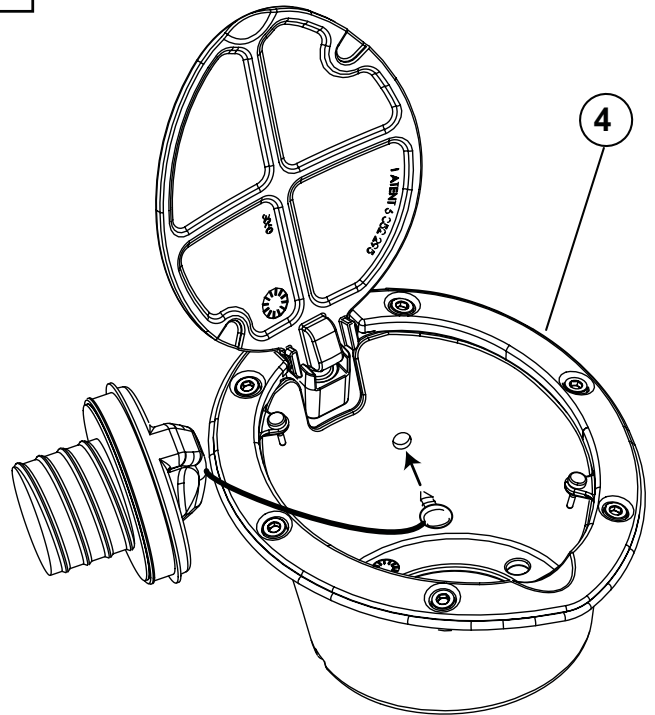

6

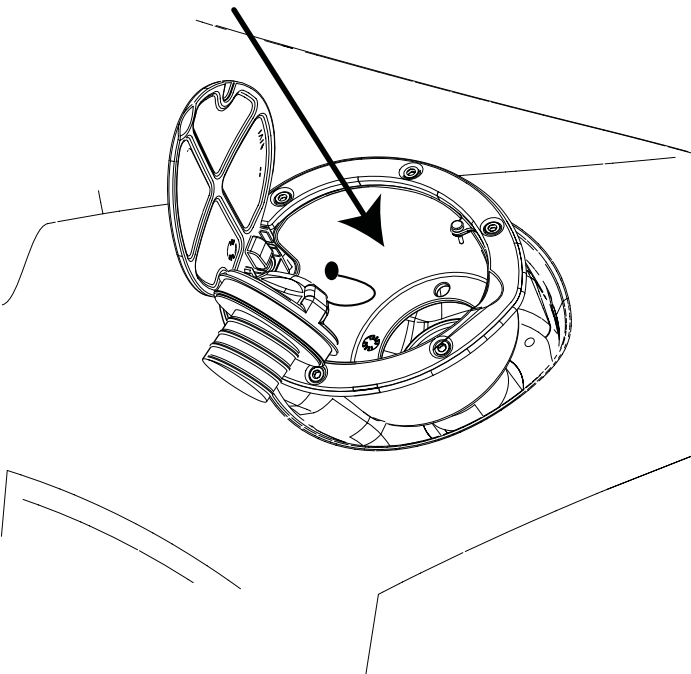

7

TORQUE BOLTS TO 5 N·m (3.7 FT-LBS).

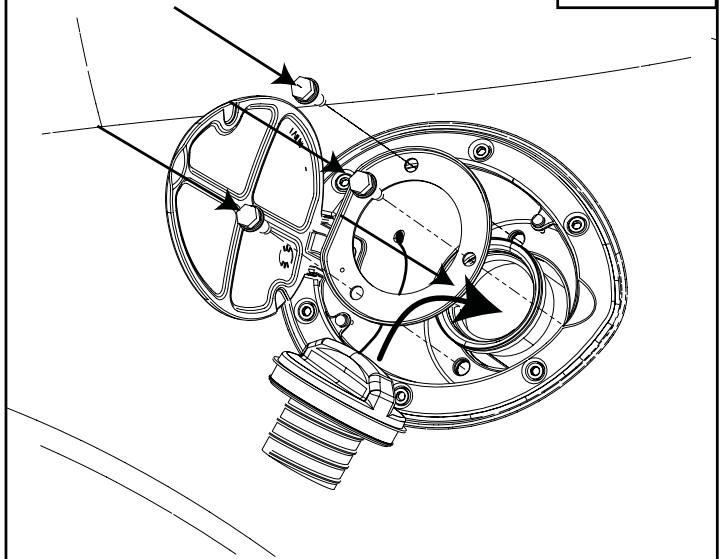
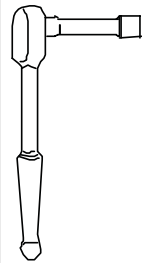

8

MAKE SURE FUEL DOOR ASSEMBLY SITS EVENLY IN POCKET. IF DOOR SITS HIGHER OR LOWER IN CERTAIN SPOTS; LOOSEN BOLTS, ADJUST MOUNTING CUP, AND RETORQUE BOLTS.

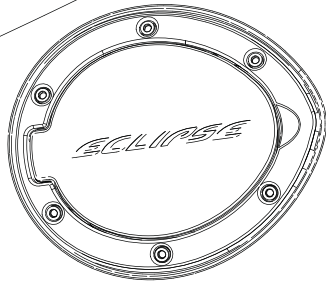

9

"PREMIUM ONLY" STICKER ON V-6 MODELS ONLY.

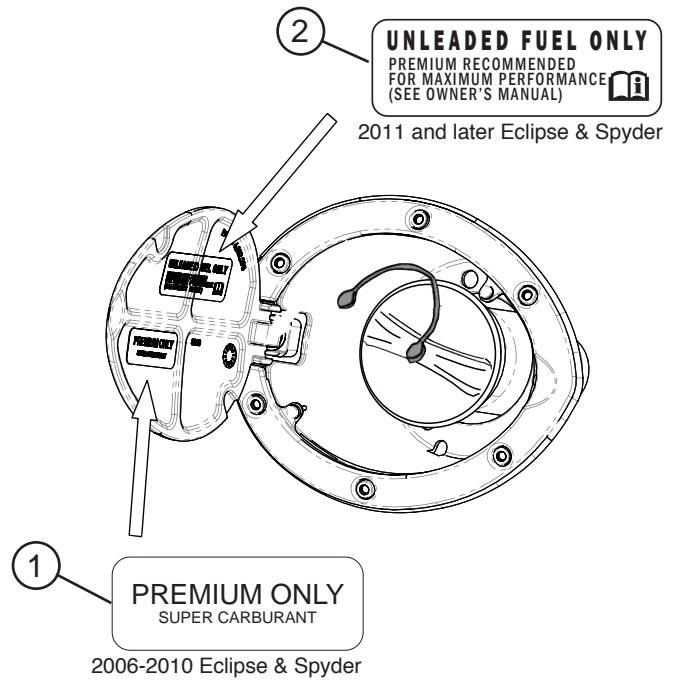



GENUINE ACCESSORIES

INSTRUCCIONES DE INSTALACIÓN

PUERTA PARA TANQUE DE GASOLINA DEL ECLIPSE

PIEZA MZ313512

APLICACIÓN

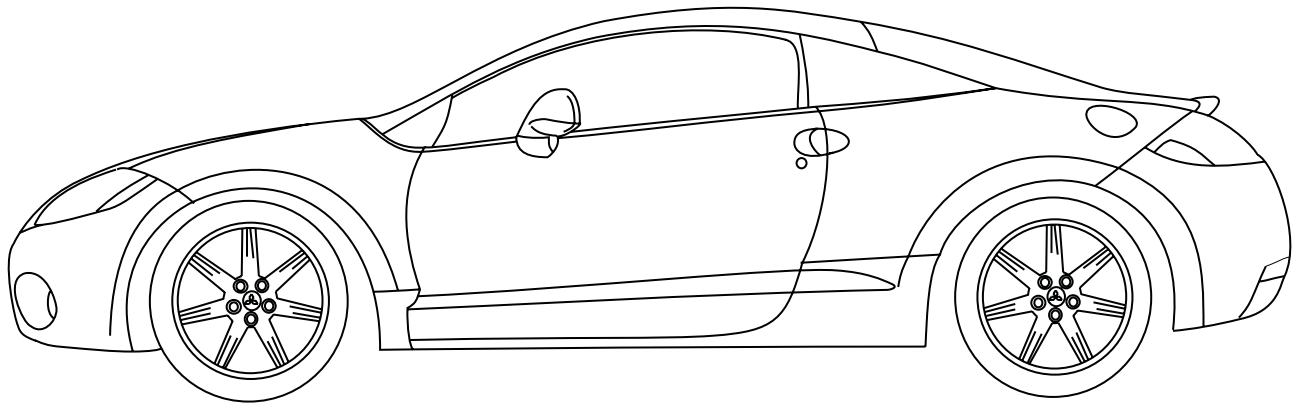

Mitsubishi Eclipse

HERRAMIENTAS NECESARIAS

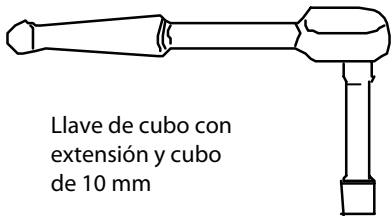

Llave de cubo con extensión y cubo de 10 mm

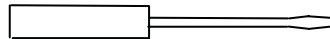

Destornillador pequeño



Solución limpiadora

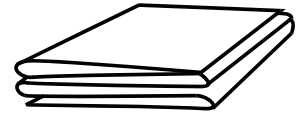

Trapo

LISTA DE MATERIALES

① X1

PREMIUM ONLY
SUPER CARBURANT

2006-2010 Eclipse & Spyder

② X1

UNLEADED FUEL ONLY
PREMIUM RECOMMENDED
FOR MAXIMUM PERFORMANCE
(SEE OWNER'S MANUAL)

2011 and later Eclipse & Spyder

③ X1

ESSENCE SANS PLOMB SEULEMENT
Essence « Super » recommandée (91 Octane ou plus)
Pour performance maximale
(Voir guide du propriétaire)

2011 and later Eclipse & Spyder

④ X1

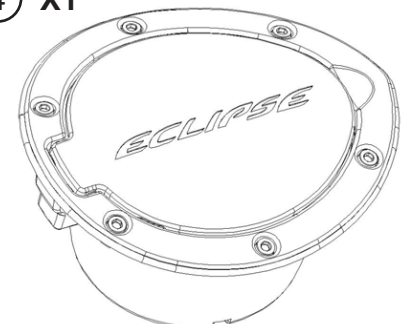

PRECAUCIÓN: EVITE QUE LOS PERNOS DE FIJACIÓN CAIGAN EN EL CONDUCTO DE ENTRADA DEL TANQUE DE GASOLINA

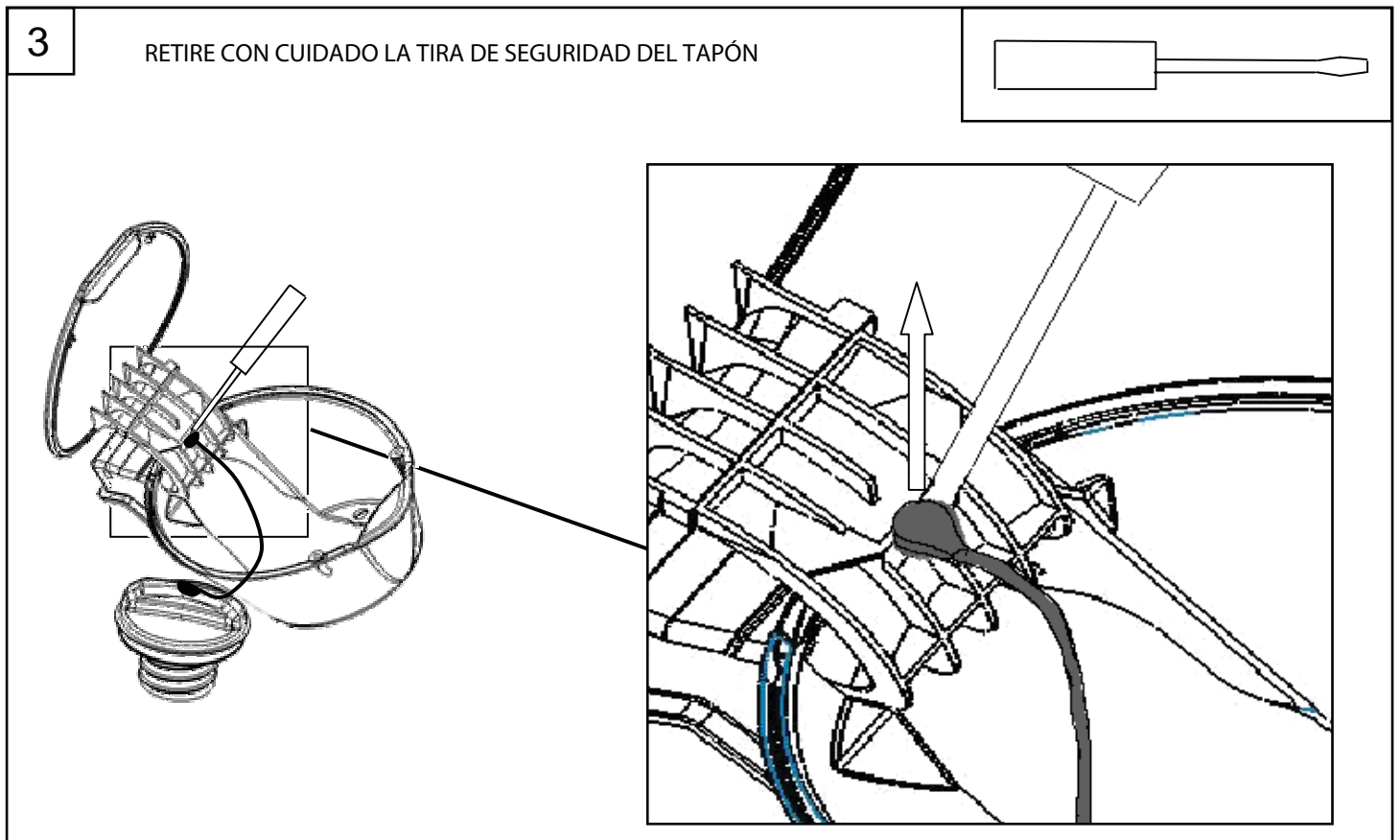
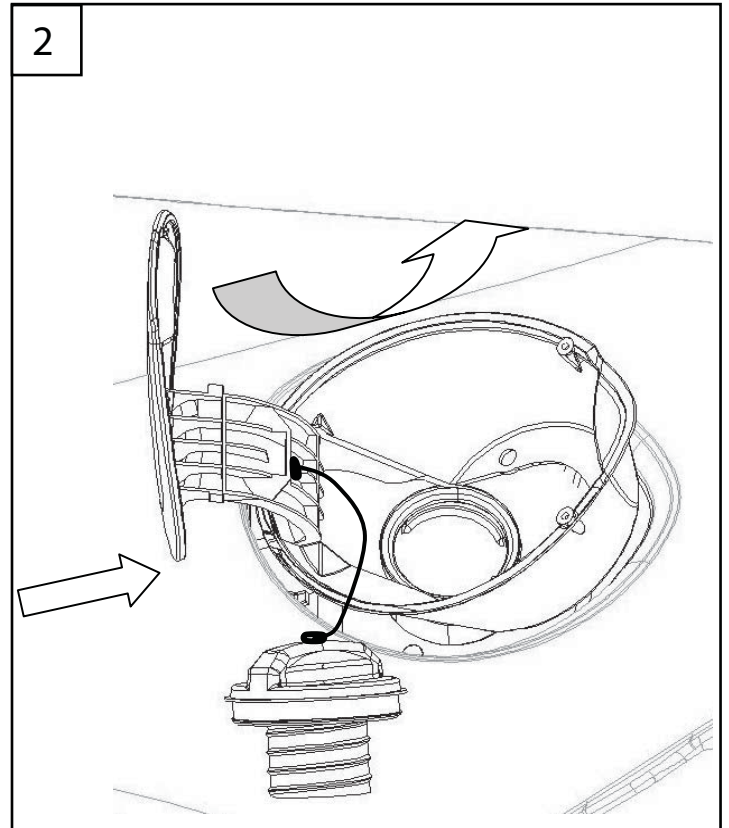
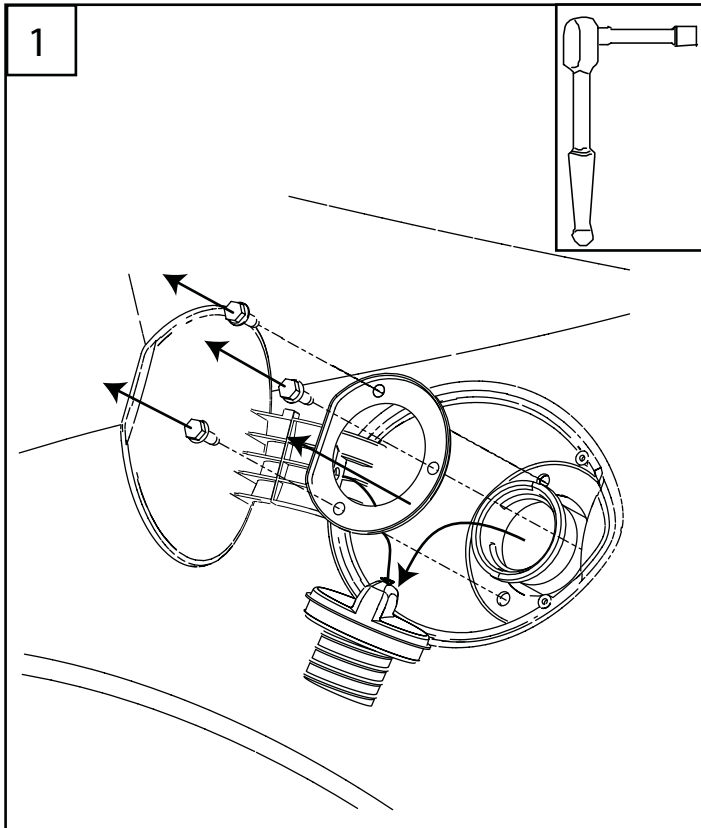

4

LIMPIE LA HOJA DE METAL CON UN TRAPO HÚMEDO Y LA SOLUCIÓN LIMPIADORA.

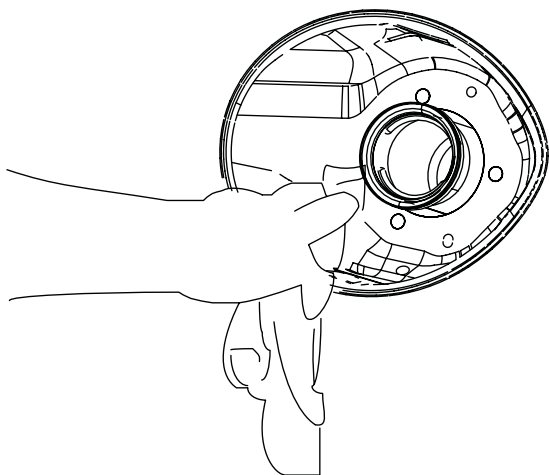
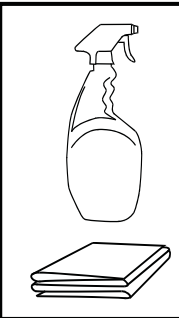

5

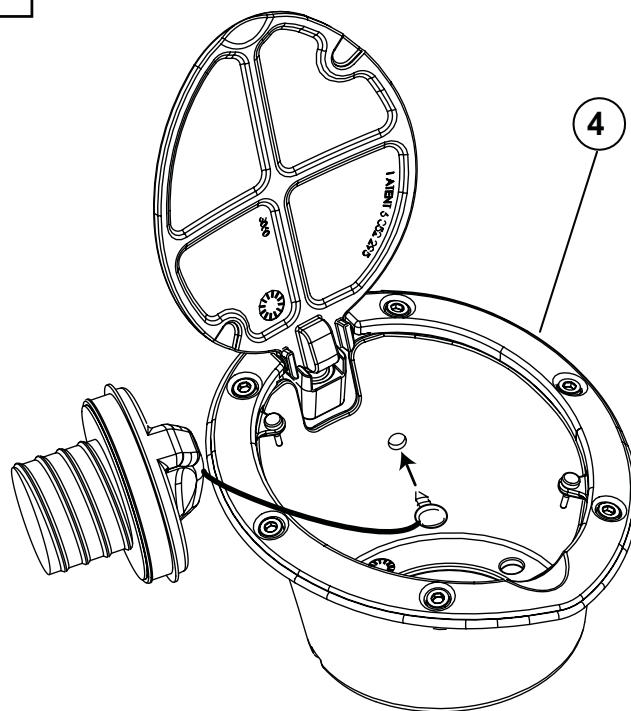

6

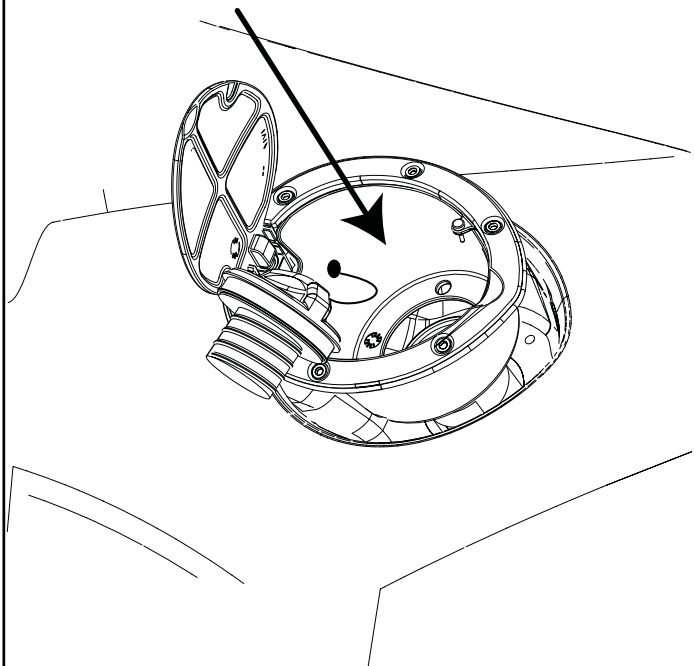

7

APRIETE LOS PERNOS CON UN TORQUE DE 5 Nm (3.7 PIES POR LIBRA)

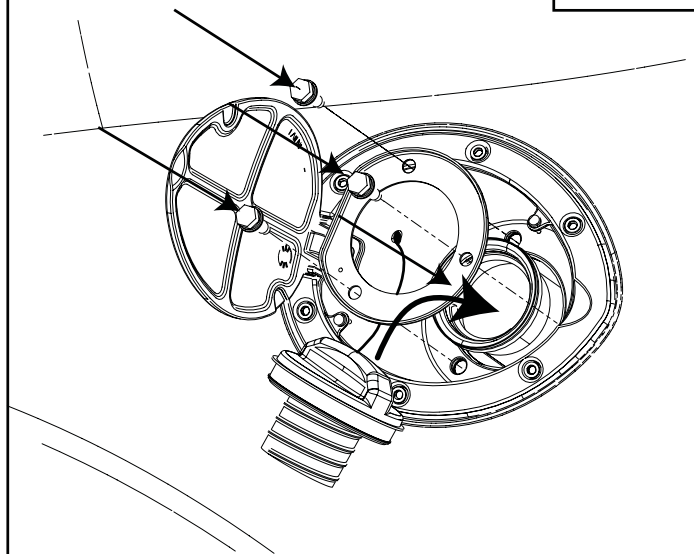
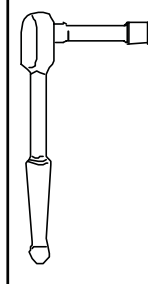

8

ASEGÚRESE DE QUE LA PUERTA DEL TANQUE DE GASOLINA SE ASIENTE POR IGUAL EN EL HUECO. SI LA PUERTA ESTUVIERA MÁS ALTA O MÁS BAJA EN UNOS SITIOS QUE EN OTROS; SUELTE LOS PERNOS, AJUSTE LA COPA DE MONTAJE Y VUELVA A APRETAR LOS PERNOS.

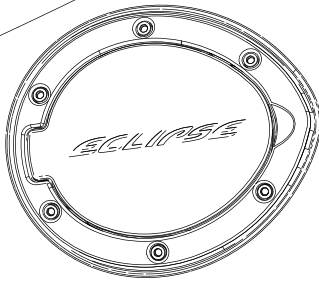

9

CALCOMANÍA "PREMIUM ONLY" SÓLO EN LOS MODELOS V-6.

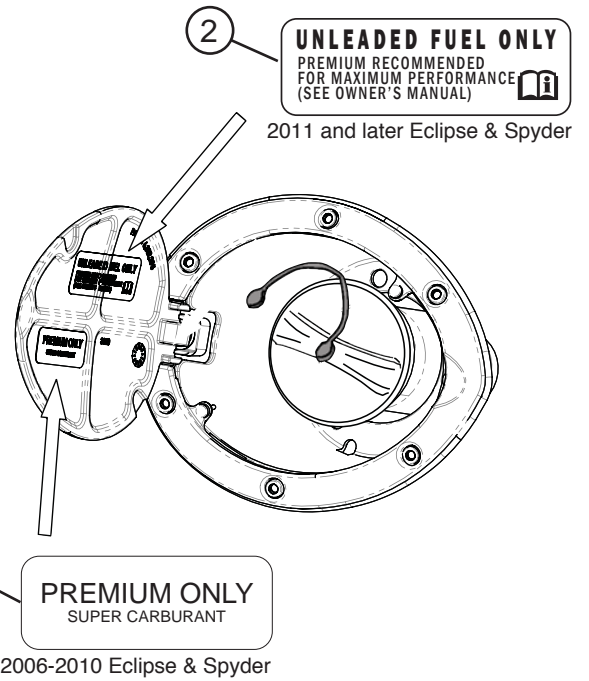



GENUINE ACCESSORIES

NOTICE D'INSTALLATION

VOLET D'ACCÈS AU RÉSERVOIR

PIÈCE N° MZ313512

APPLICATION

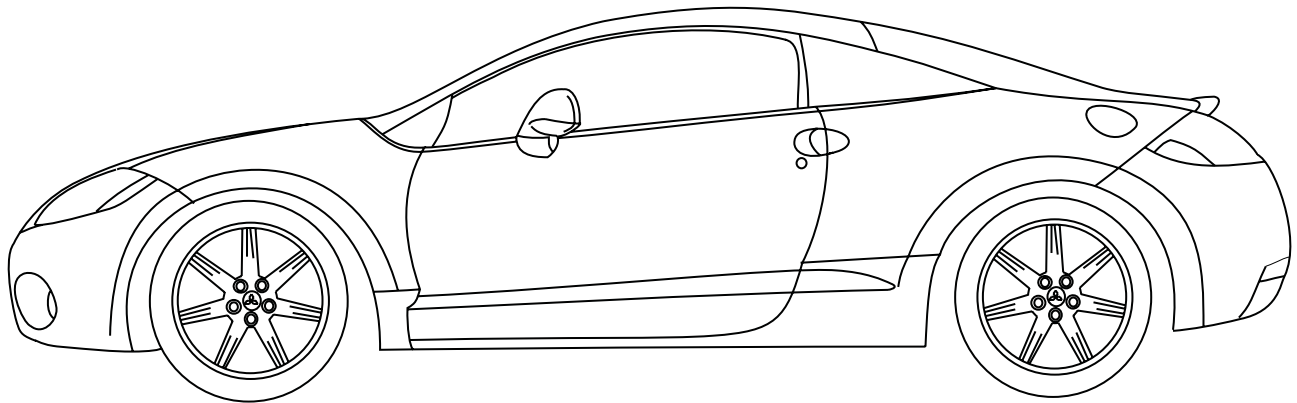

Mitsubishi Eclipse

OUTILS NÉCESSAIRES

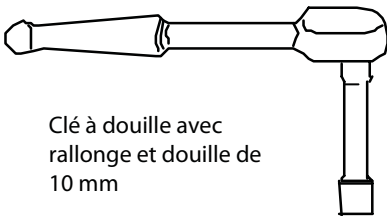

Clé à douille avec rallonge et douille de 10 mm

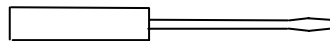

Petit tournevis



Solution de nettoyage

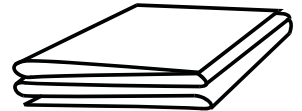

Tissu doux

NOMENCLATURE

① X1

PREMIUM ONLY
SUPER CARBURANT

2006-2010 Eclipse & Spyder

② X1

UNLEADED FUEL ONLY
PREMIUM RECOMMENDED
FOR MAXIMUM PERFORMANCE
(SEE OWNER'S MANUAL)

2011 and later Eclipse & Spyder

③ X1

ESSENCE SANS PLOMB SEULEMENT
Esence « Super » recommandée (91 Octane ou plus)
Pour performance maximale
(Voir guide du propriétaire)

2011 and later Eclipse & Spyder

④ X1

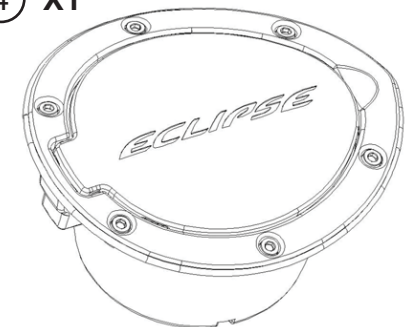

ATTENTION : NE PAS LAISSER TOMBER LES BOULONS D'INSTALLATION DANS LE TUYAU DE REMPLISSAGE DU RÉSERVOIR

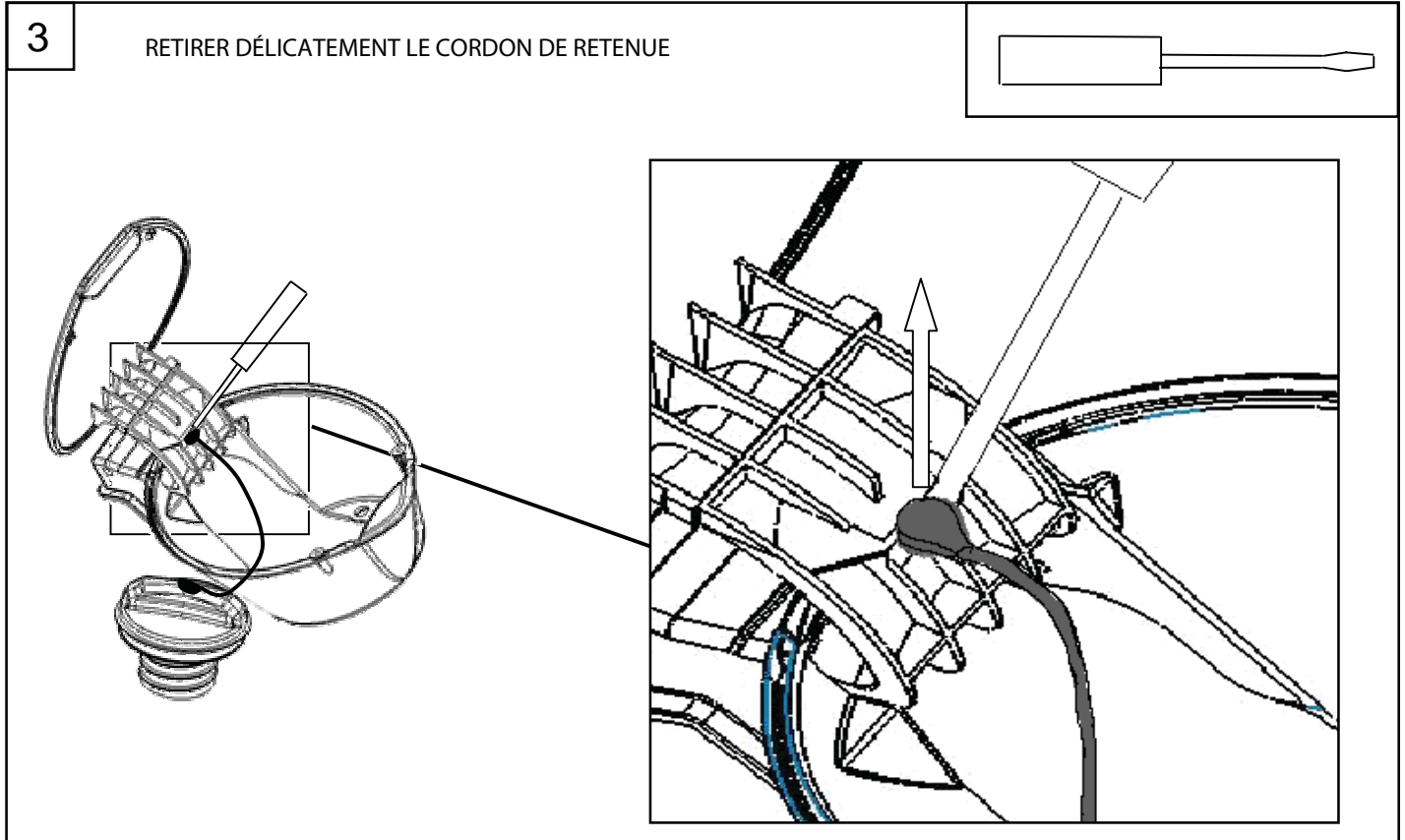
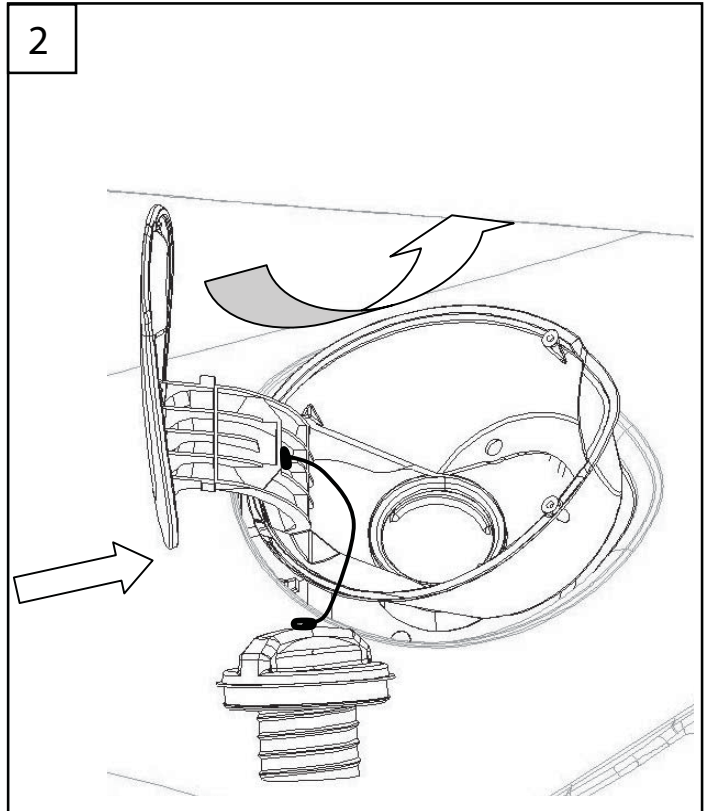
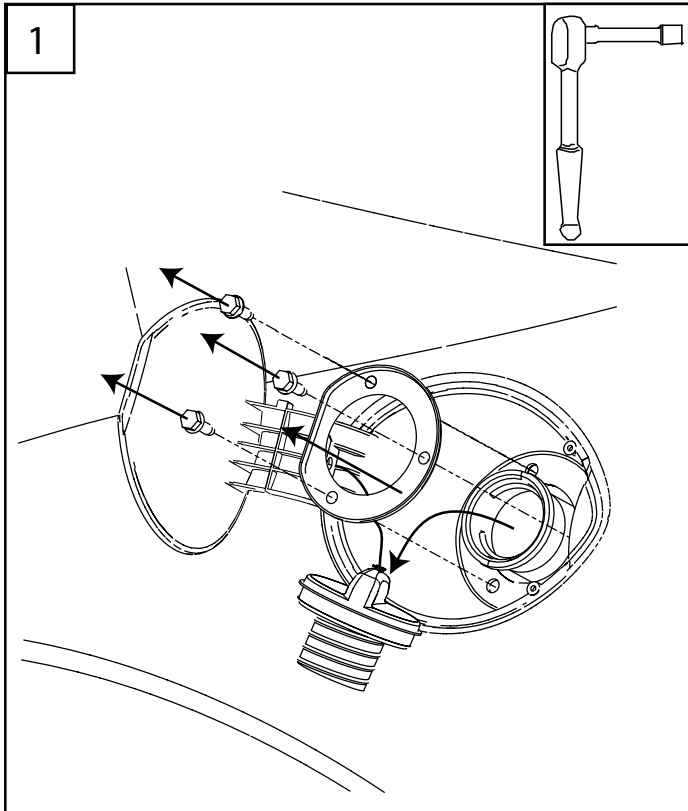

4

NETTOYER LE MÉTAL AVEC
UN TISSU HUMIDE ET UNE
SOLUTION DE NETTOYAGE.

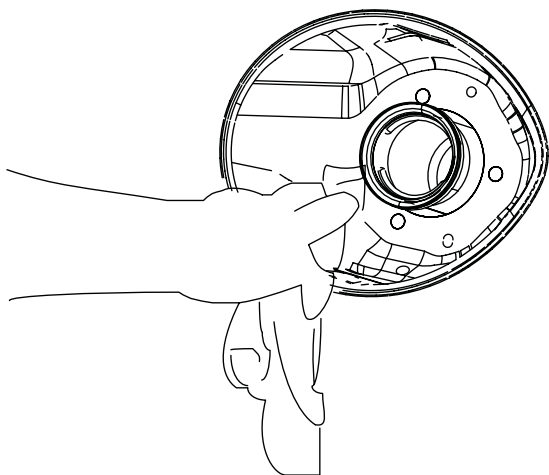
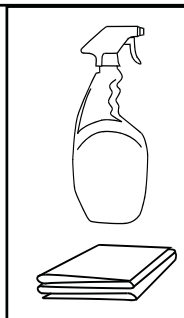

5

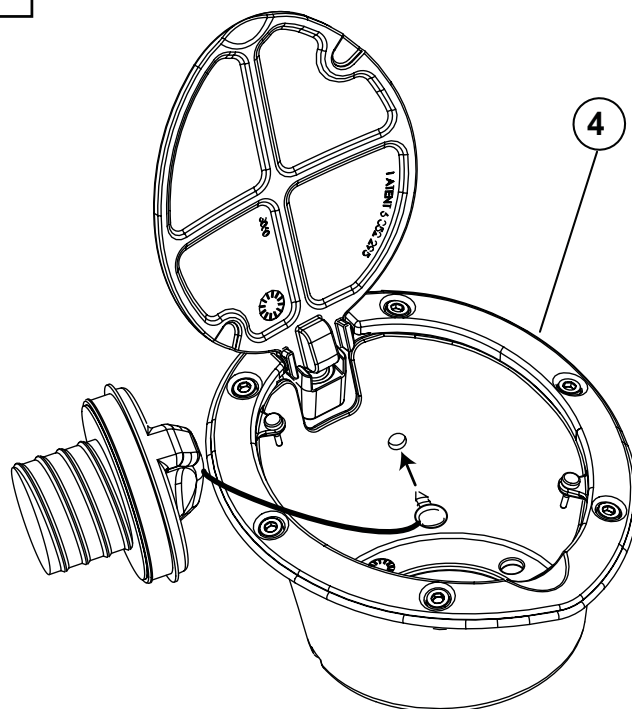

6

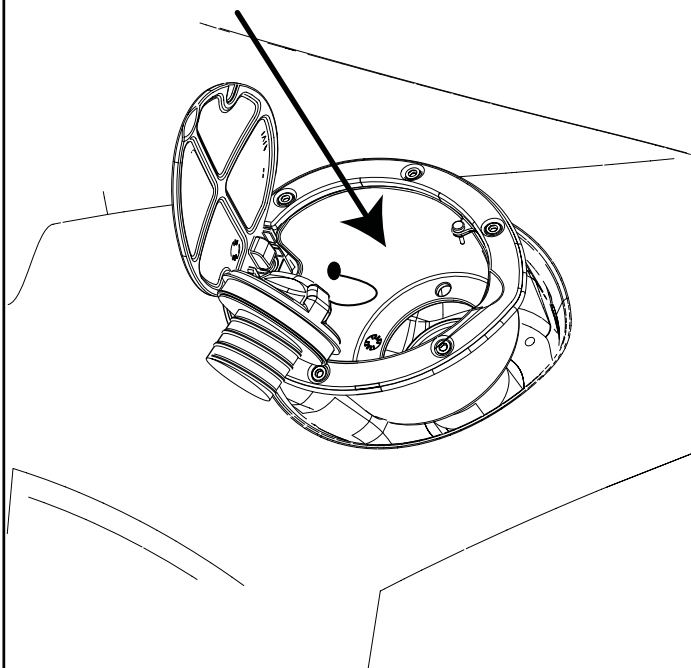

7

SERRER LES BOULONS AVEC
UN COUPLE DE 5 N•m (3,7 lb•pi)

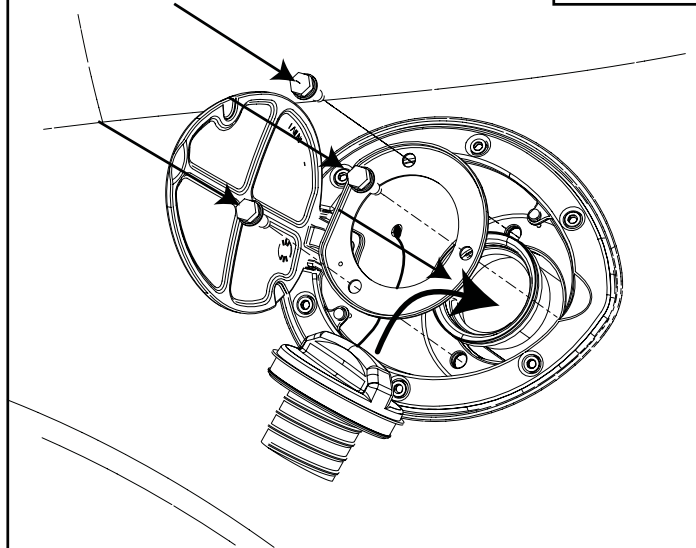
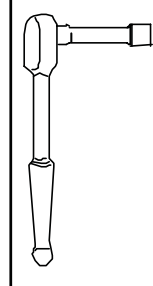

8

S'ASSURER QUE LE VOLET D'ACCÈS AU RÉSERVOIR SE FERME CORRECTEMENT SUR LA CAVITÉ. SI LE VOLET EST PLUS SORTI OU PLUS ENFONCÉ À CERTAINS ENDROITS, DESSERRER LES BOULONS, AJUSTER LA COUPELLE DE MONTAGE ET RESSERRER LES BOULONS.

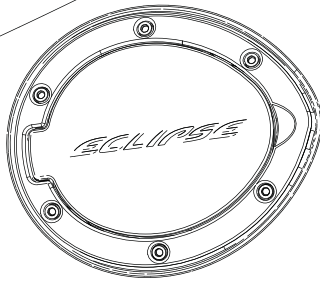

9

L'AUTOCOLLANT « PREMIUM ONLY » NE DOIT ÊTRE INSTALLÉ QUE SUR LES MODÈLES V-6.

